

Garaż Jodła 6,01 x 3,76 m



Garaż Jodła 6,01x3,76m - Zestawienie materiału

Długości rzeczywiste

| NrS | Przeznaczenie | NrZ | szt | B [cm] | H [cm] | L [m] |
|---------------|----------------------|------------|------------|-------------------|-------------------|------------------|
| 50 | deska zamykająca | C24 | 2 | 2,4 | 14,0 | 4,406 |
| 51, 52, 53 | krokwie | C24 | 9 | 6,0 | 14,0 | 4,406 |
| 54 | deska zamykająca | C24 | 2 | 2,4 | 14,0 | 6,854 |
| 55 | deska zamykająca | C24 | 8 | 2,4 | 13,6 | 0,723 |
| 56 | deska zamykająca | C24 | 8 | 2,4 | 15,3 | 0,723 |
| | | | | | | |
| 100 | podwalina | C24 | 2 | 6,0 | 12,0 | 6,014 |
| 101 | podwalina | C24 | 2 | 6,0 | 12,0 | 6,254 |
| 102 | oczep | C24 | 4 | 6,0 | 12,0 | 6,254 |
| 103 | podwalina | C24 | 1 | 6,0 | 12,0 | 3,766 |
| 104 | podwalina | C24 | 1 | 6,0 | 12,0 | 3,526 |
| | | | | | | |
| 105, 108 | oczep | C24 | 2 | 6,0 | 12,0 | 3,589 |
| 106 | podwalina | C24 | 2 | 6,0 | 12,0 | 0,633 |
| 107 | podwalina | C24 | 2 | 6,0 | 12,0 | 0,513 |
| 109 | słupy narożne | C24 | 2 | 6,0 | 12,0 | 2,268 |
| 110 | słup | C24 | 3 | 6,0 | 12,0 | 2,268 |
| | | | | | | |
| 111 | słupy okienne | C24 | 2 | 6,0 | 12,0 | 2,268 |
| 112 | słup | C24 | 2 | 6,0 | 12,0 | 1,134 |
| 113 | słup | C24 | 2 | 6,0 | 12,0 | 0,387 |
| 114 | Fensterpfosten | C24 | 2 | 6,0 | 12,0 | 2,268 |
| 115, 135 | słupy narożne | C24 | 2 | 6,0 | 12,0 | 2,945 |
| | | | | | | |
| 116 | słup | C24 | 1 | 6,0 | 12,0 | 2,862 |
| 117 | słup | C24 | 1 | 6,0 | 12,0 | 2,754 |
| 118 | słup | C24 | 1 | 6,0 | 12,0 | 2,647 |

| NrS | Przeznaczenie | NrZ | szt | B [cm] | H [cm] | L [m] |
|-------------|----------------|-----|-----|-----------|-----------|----------|
| 119 | słup | C24 | 1 | 6,0 | 12,0 | 2,539 |
| 120 | słup | C24 | 1 | 6,0 | 12,0 | 2,431 |
| 121, 124 | słupy narożne | C24 | 2 | 6,0 | 12,0 | 2,348 |
| 122 | słupy narożne | C24 | 2 | 6,0 | 12,0 | 2,895 |
| 123 | słup | C24 | 9 | 6,0 | 12,0 | 2,895 |
| 125 | słupy drzwiowe | C24 | 1 | 6,0 | 12,0 | 2,416 |
| 126 | słupy drzwiowe | C24 | 2 | 6,0 | 12,0 | 1,980 |
| 127 | słupy drzwiowe | C24 | 1 | 6,0 | 12,0 | 0,266 |
| 128 | słup | C24 | 1 | 6,0 | 12,0 | 0,277 |
| 129 | słup | C24 | 1 | 6,0 | 12,0 | 0,377 |
| 130 | słup | C24 | 1 | 6,0 | 12,0 | 0,485 |
| 131 | słup | C24 | 1 | 6,0 | 12,0 | 0,593 |
| 132 | słup | C24 | 1 | 6,0 | 12,0 | 0,696 |
| 133 | słupy drzwiowe | C24 | 1 | 6,0 | 12,0 | 0,707 |
| 134 | słupy drzwiowe | C24 | 1 | 6,0 | 12,0 | 2,877 |
| 136 | belka-parapet | C24 | 2 | 6,0 | 12,0 | 1,194 |
| 137 | belka-nadproze | C24 | 2 | 6,0 | 12,0 | 1,194 |
| 138 | belka-nadproze | C24 | 3 | 6,0 | 12,0 | 2,620 |

| NrZ | szt [szt] | Dług. [m] | Kub. [m ³] | Masa [kg] |
|----------------|--------------|---------------|---------------------------|--------------|
| C24 | 96 | 244,52 | 1,73 | 616 |
| Łącznie | 96 | 244,52 | 1,73 | 616 |
| C24 | | | | |
| 2,4x 13,6 | 8 | 5,78 | 0,02 | 7 |
| 2,4x 14,0 | 4 | 22,52 | 0,08 | 29 |
| 2,4x 15,3 | 8 | 5,78 | 0,02 | 7 |
| 6,0x 12,0 | 67 | 170,78 | 1,27 | 454 |
| 6,0x 14,0 | 9 | 39,66 | 0,34 | 119 |

PA 0
 ściana 1
 warstwy : 0
 NrS
 skala: 1 : 46

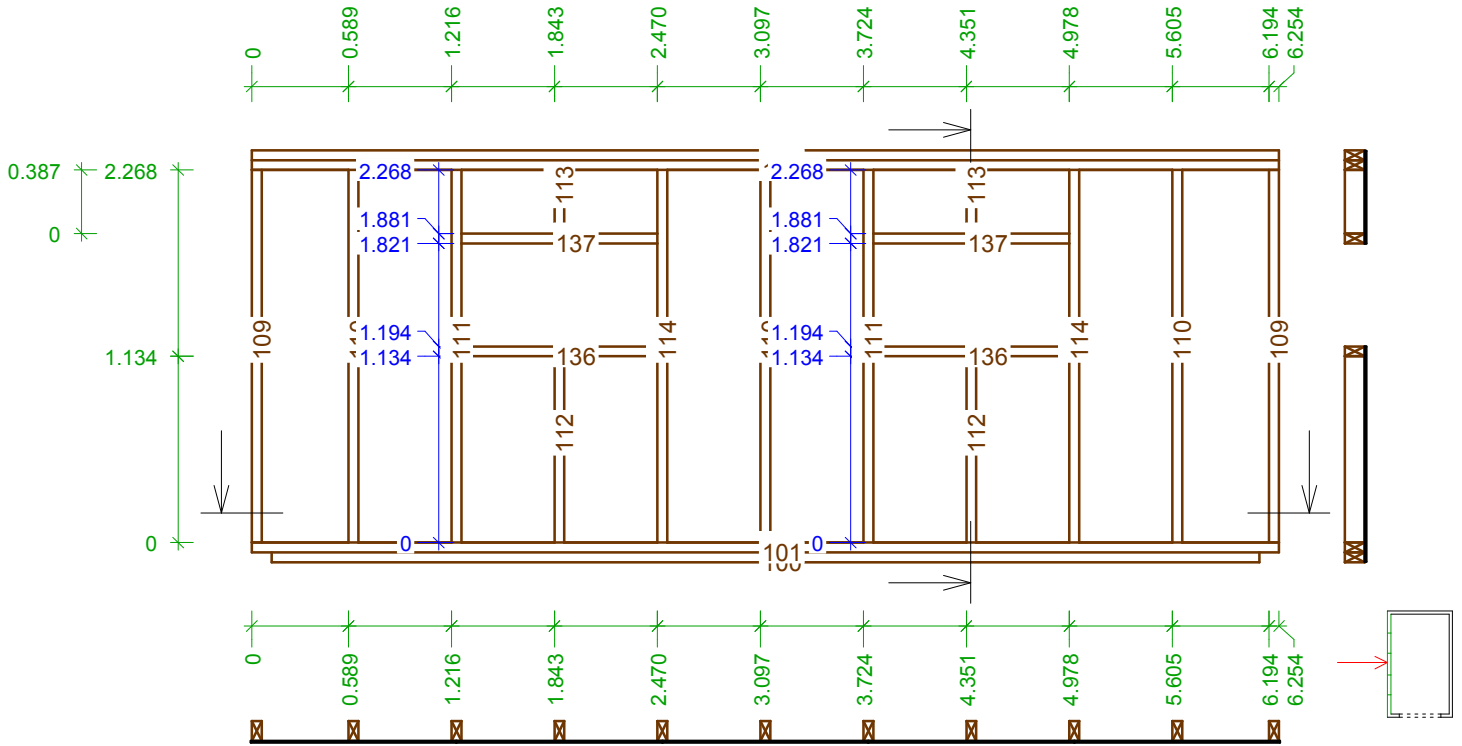

6.0 x 12.0

| | | |
|-------|-------|----|
| S100: | 601.4 | 1x |
| S101: | 625.4 | 1x |
| S102: | 625.4 | 2x |
| S109: | 226.8 | 2x |
| S110: | 226.8 | 3x |
| S111: | 226.8 | 2x |
| S112: | 113.4 | 2x |
| S113: | 38.7 | 2x |
| S114: | 226.8 | 2x |
| S136: | 119.4 | 2x |
| S137: | 119.4 | 2x |

PA 0
 ściana 1
 warstwy : -2, 0
 skala: 1 : 46

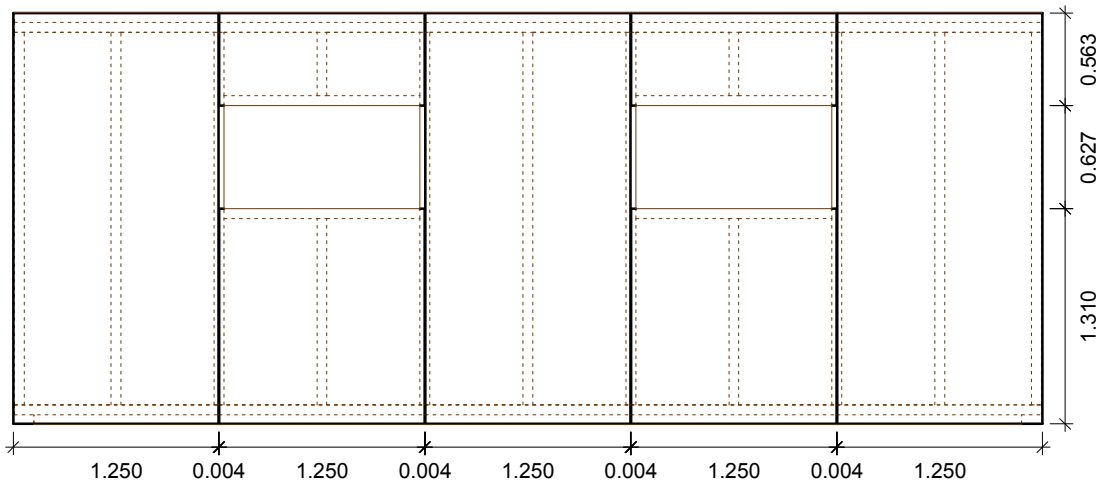

PA 0
ściana 2
warstwy : 0
NrS
skala: 1 : 41

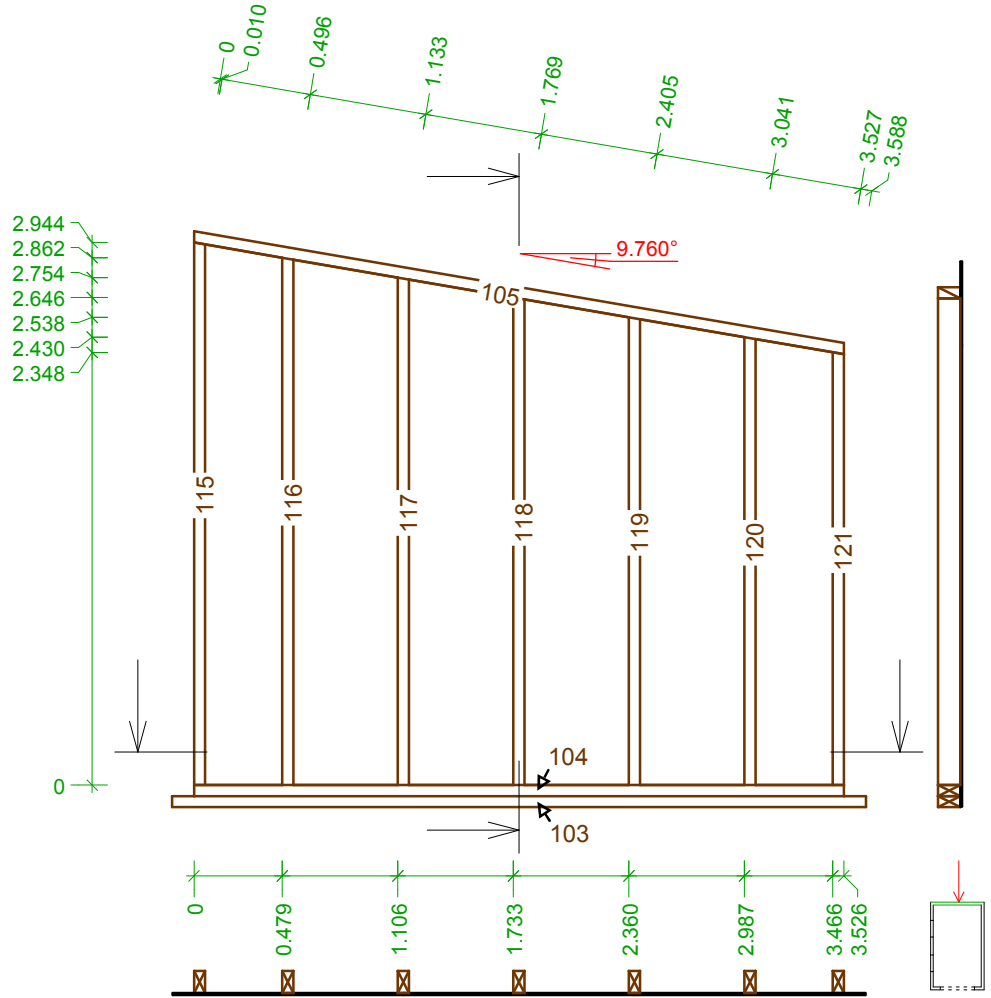

6.0 x 12.0

| | | |
|-------|-------|----|
| S103: | 376.6 | 1x |
| S104: | 352.6 | 1x |
| S105: | 358.8 | 1x |
| S115: | 294.4 | 1x |
| S116: | 286.2 | 1x |
| S117: | 275.4 | 1x |
| S118: | 264.6 | 1x |
| S119: | 253.8 | 1x |
| S120: | 243.0 | 1x |
| S121: | 234.8 | 1x |

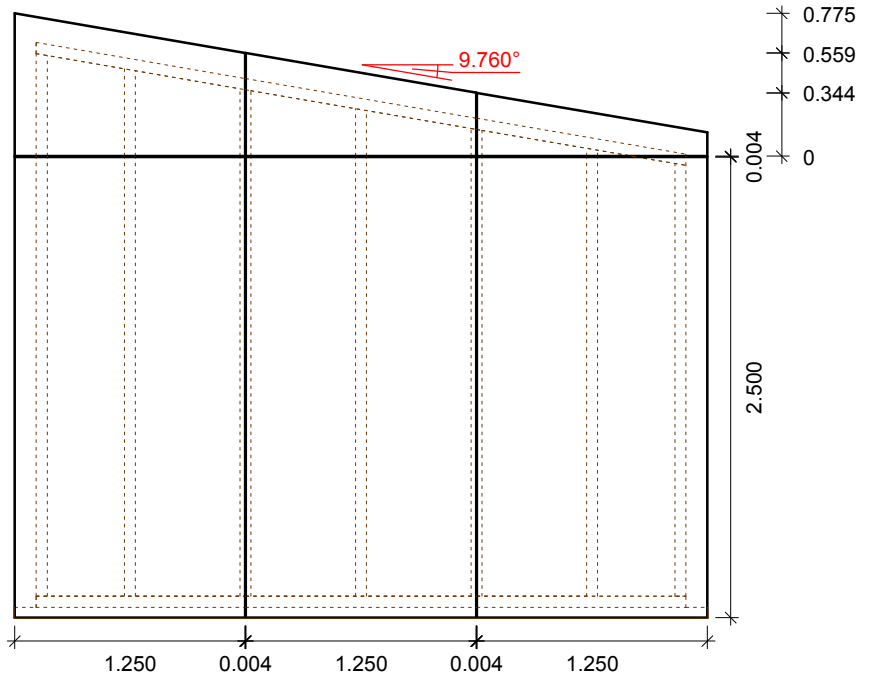

PA 0
ściana 2
warstwy : -2, 0
skala: 1 : 41

PA 0
 ściana 3
 warstwy : 0
 NrS
 skala: 1 : 47

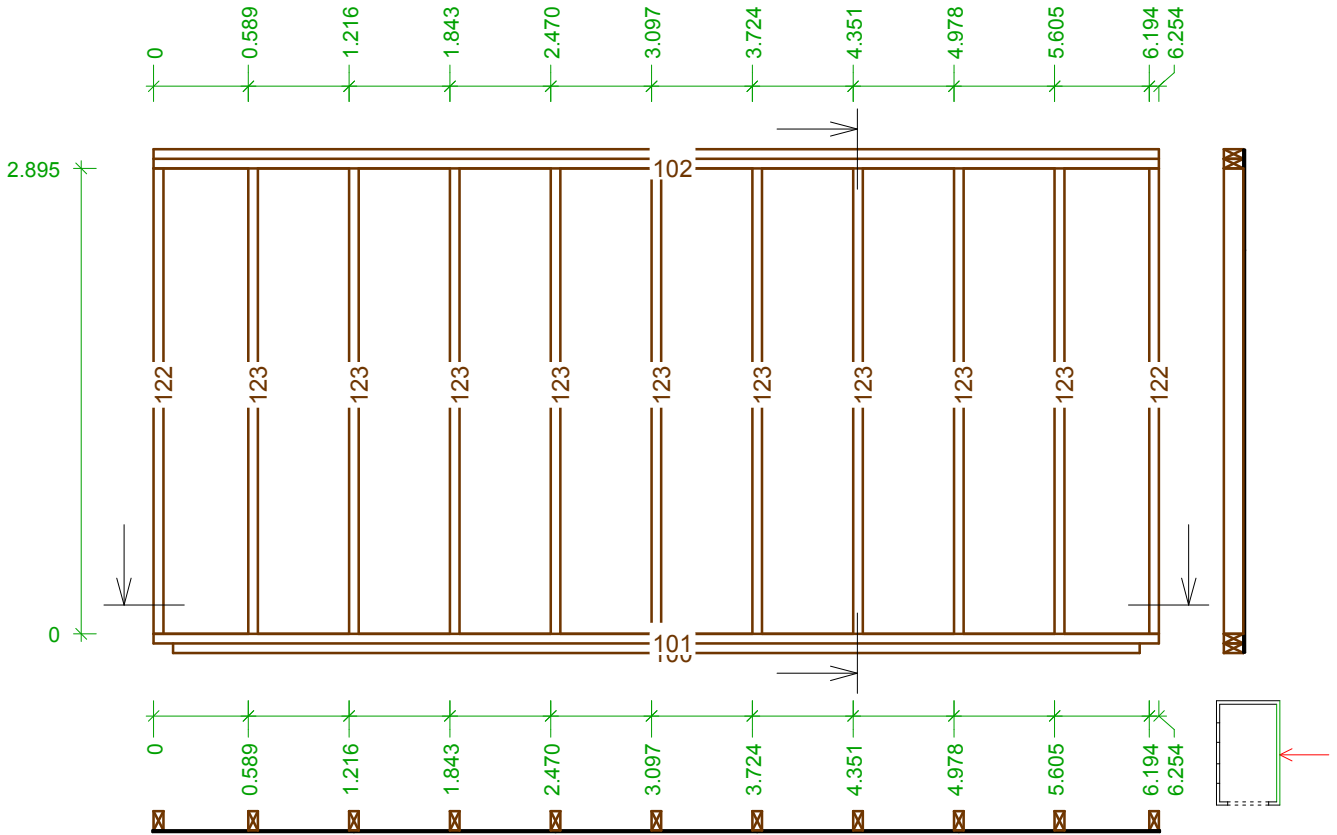

6.0 x 12.0

| | | |
|-------|-------|----|
| S100: | 601.4 | 1x |
| S101: | 625.4 | 1x |
| S102: | 625.4 | 2x |
| S122: | 289.5 | 2x |
| S123: | 289.5 | 9x |

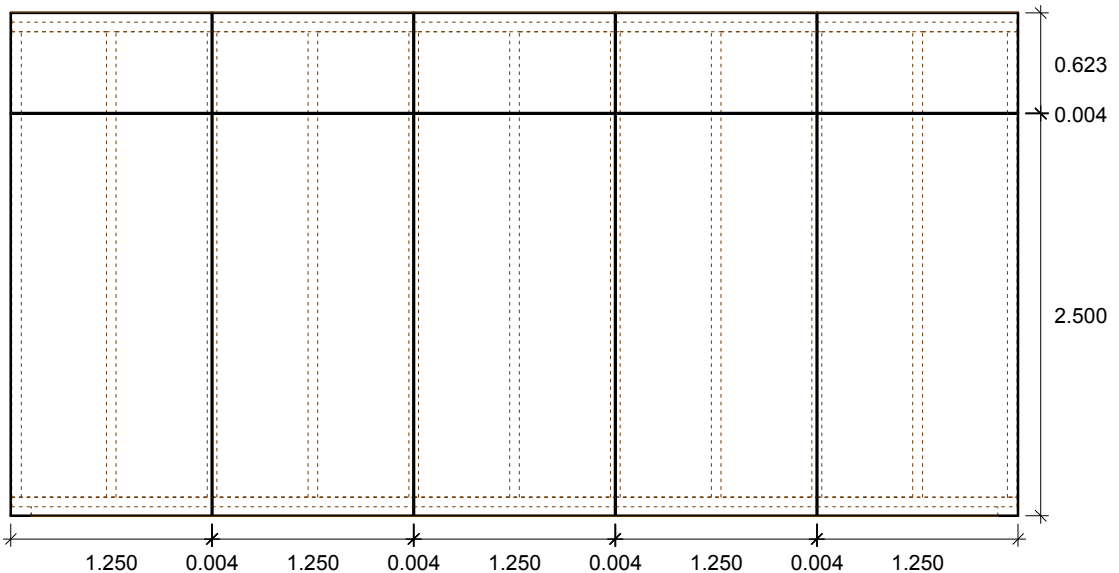

PA 0
 ściana 3
 warstwy : -2, 0
 skala: 1 : 47

PA 0
 ściana 4
 warstwy : 0
 NrS
 skala: 1 : 39

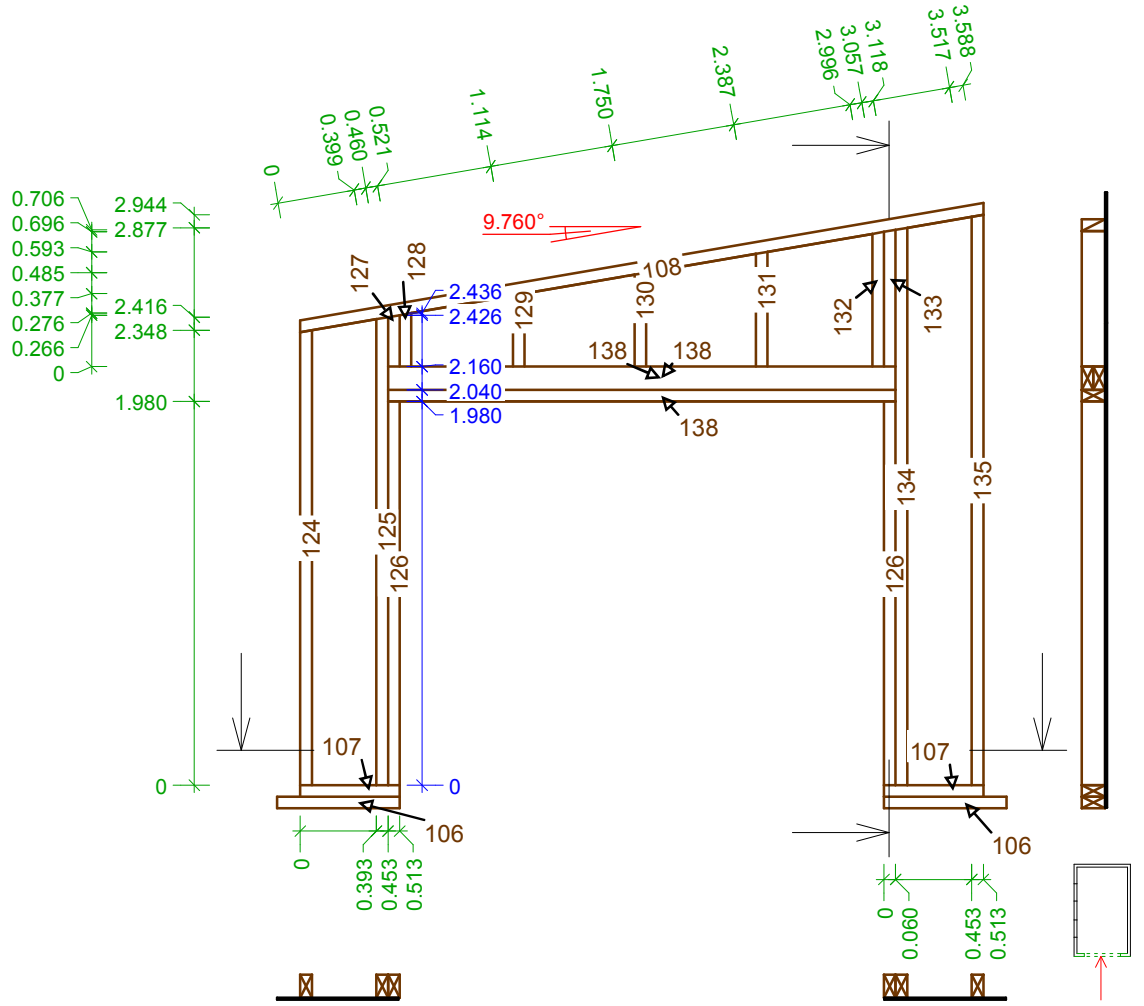

| 6.0 x 12.0 | | |
|------------|-------|----|
| S106: | 63.3 | 2x |
| S107: | 51.3 | 2x |
| S108: | 358.8 | 1x |
| S124: | 234.8 | 1x |
| S125: | 241.6 | 1x |
| S126: | 198.0 | 2x |
| S127: | 26.6 | 1x |
| S128: | 27.6 | 1x |
| S129: | 37.7 | 1x |
| S130: | 48.5 | 1x |
| S131: | 59.3 | 1x |
| S132: | 69.6 | 1x |
| S133: | 70.6 | 1x |
| S134: | 287.7 | 1x |
| S135: | 294.4 | 1x |
| S138: | 262.0 | 3x |

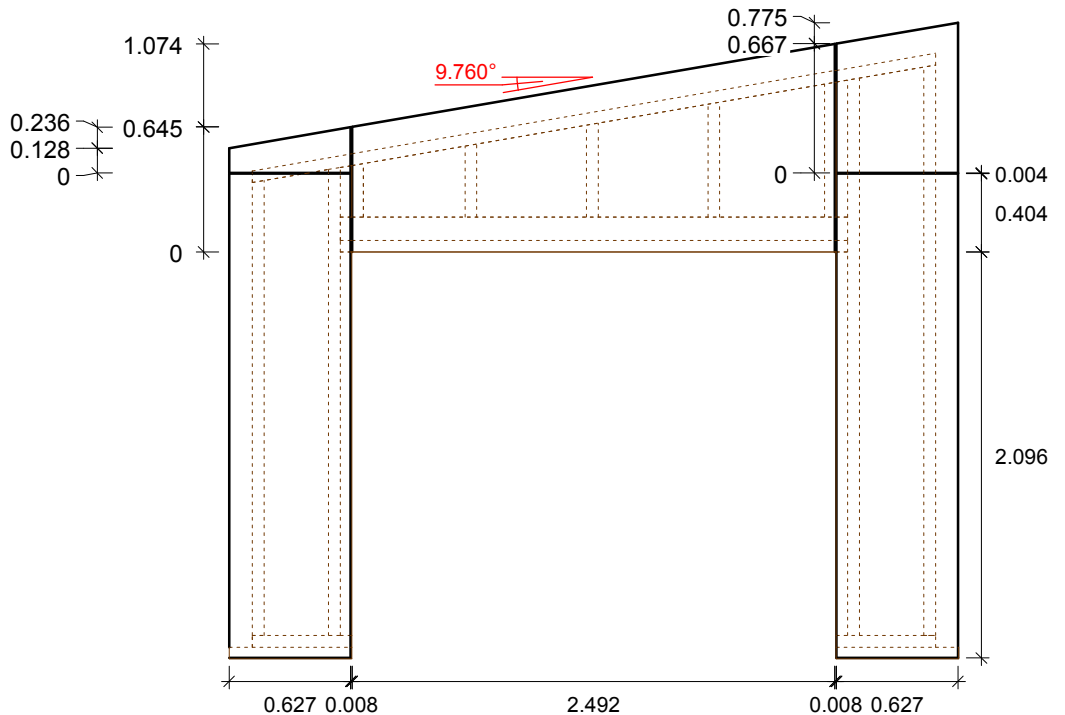

PA 0
 ściana 4
 warstwy : -2, 0
 skala: 1 : 39

rzut więzby
oznaczenie elementów - NrS
skala:
1 : 40

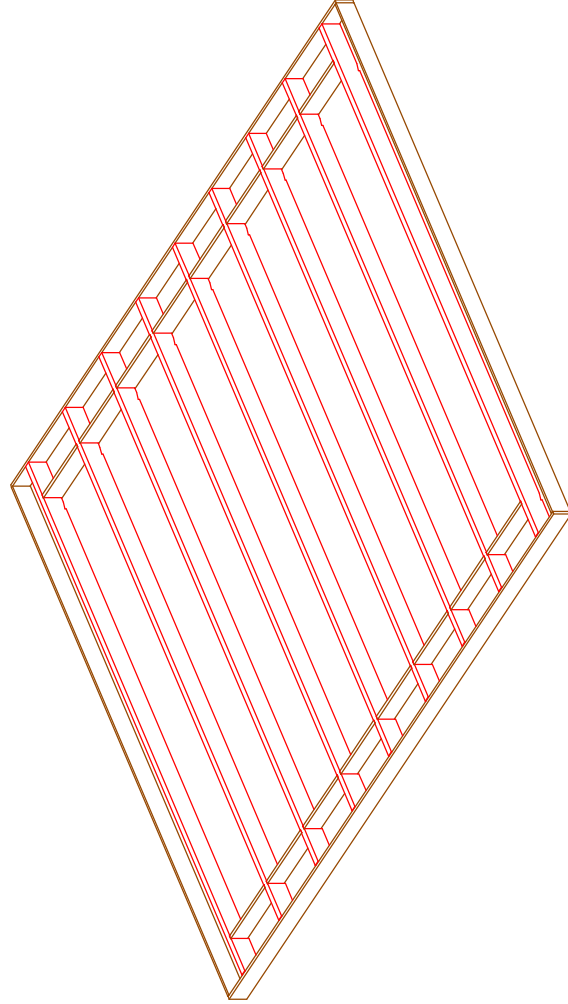
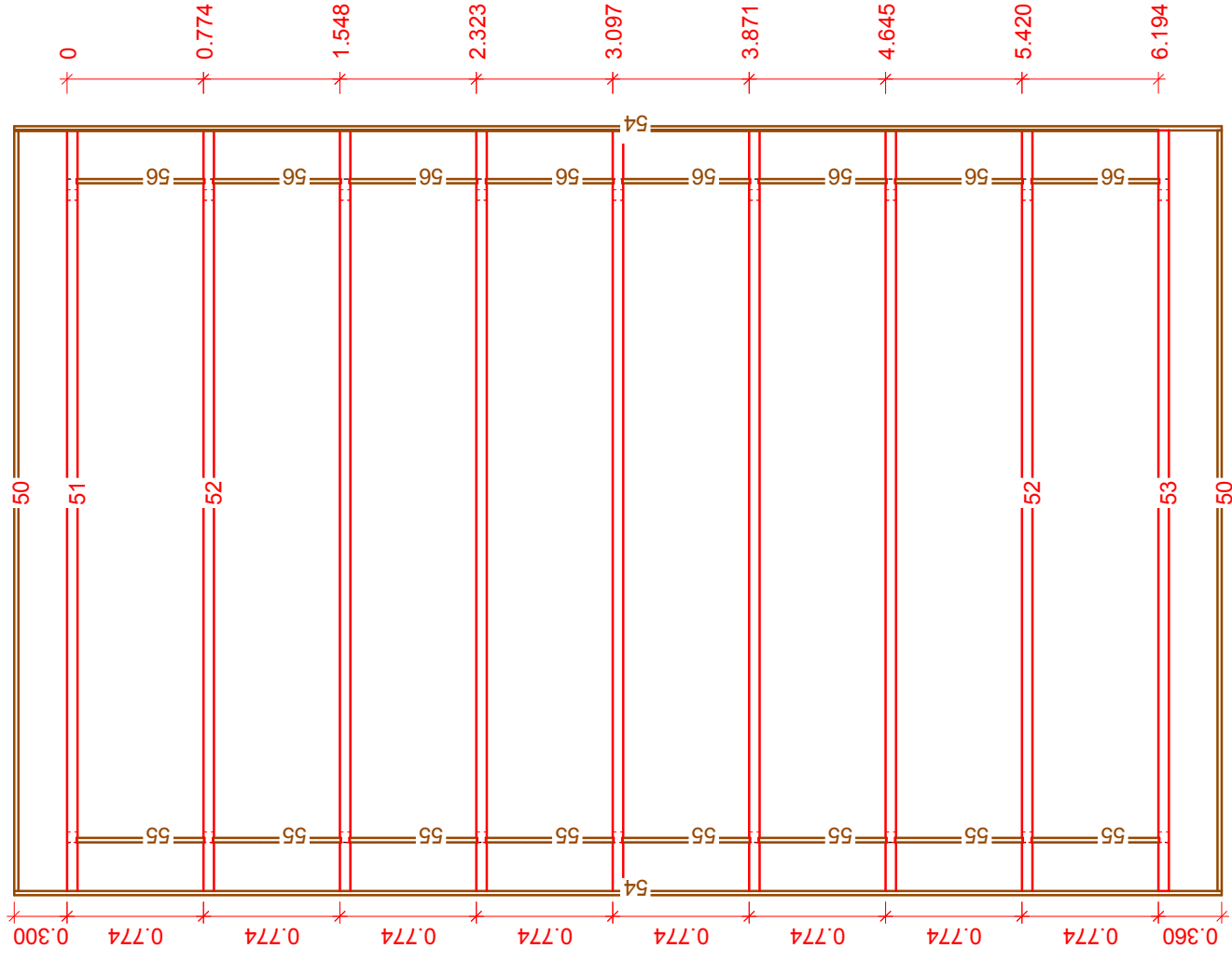

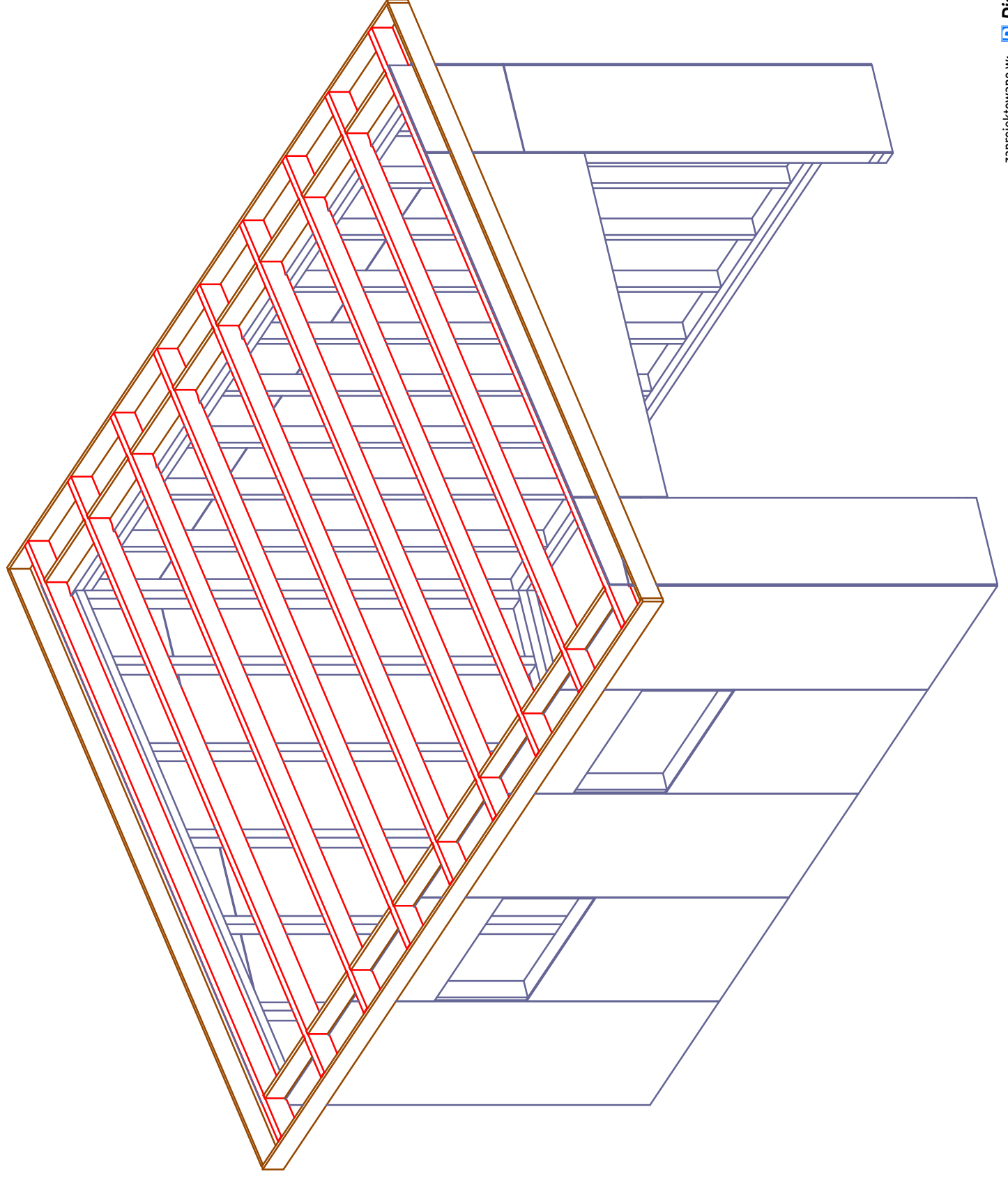

rysunek-podwalin
PA 0
przekrój poziomy: 4.000
NrS
skala: 1 : 37

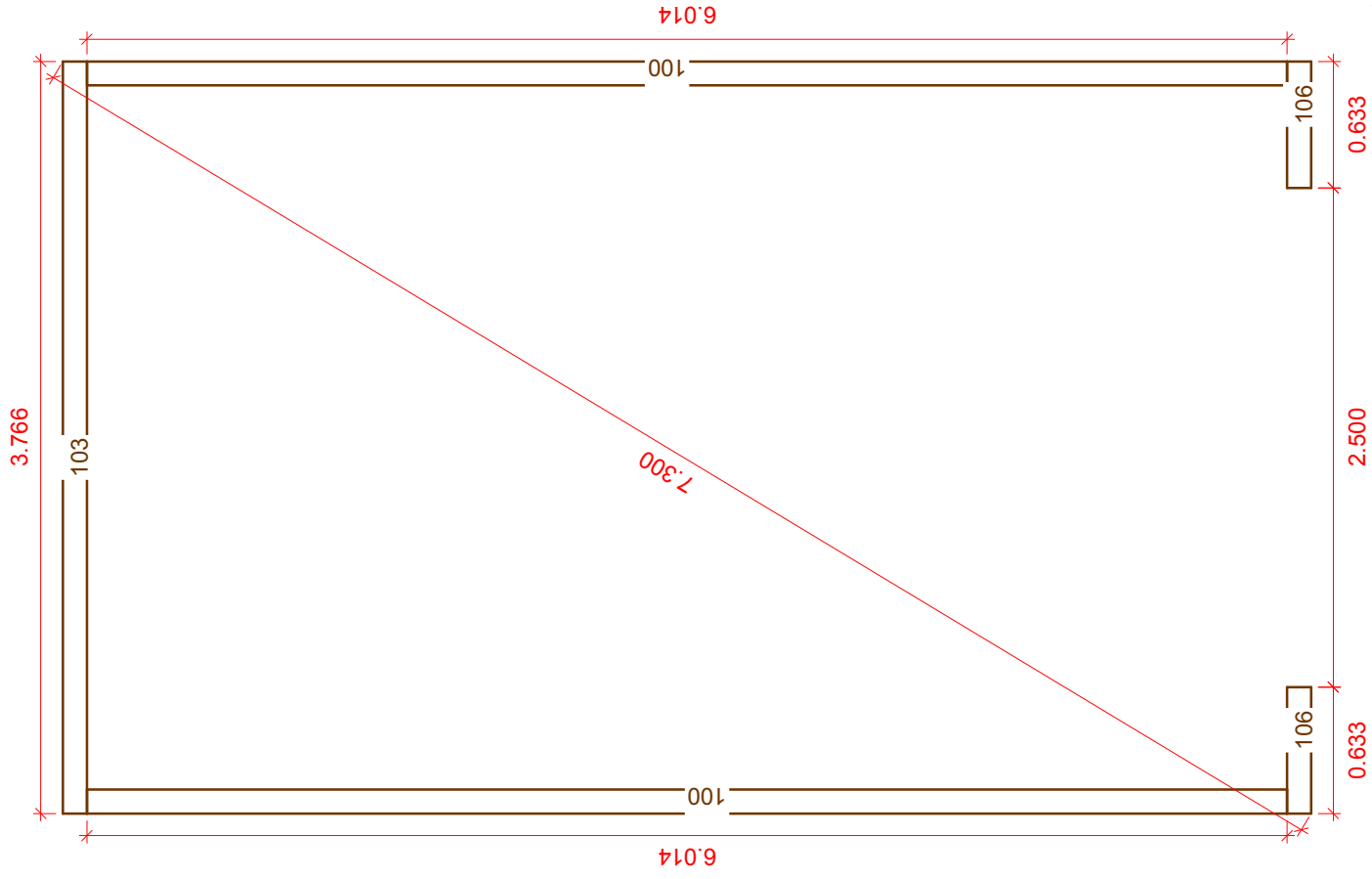

deska zamykająca: 0.024 / 0.140
 NrS x ilość: 50, 2 szt
 długość: 4.405 m
 nachylenie: 9.8 st
 skala: 1 : 25

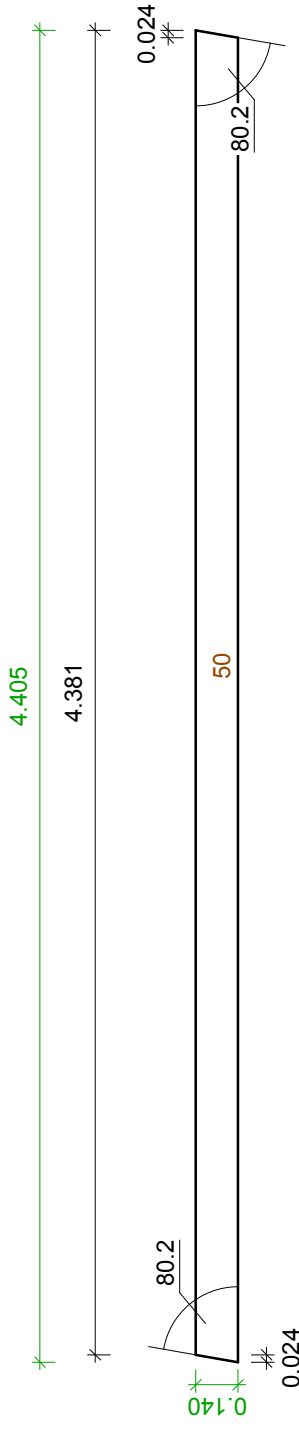

deska zamykająca: 0.024 / 0.140
 NrS x ilość: 54, 2 szt
 długość: 6.854 m
 skala: 1 : 25

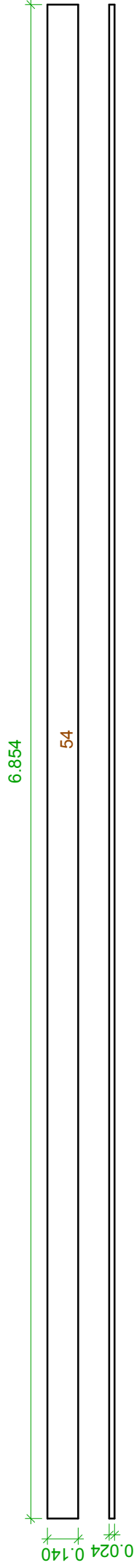

deska zamykająca: 0.024 / 0.136
 NrS x ilość: 55, 8 szt
 długość: 0.722 m
 skala: 1 : 25

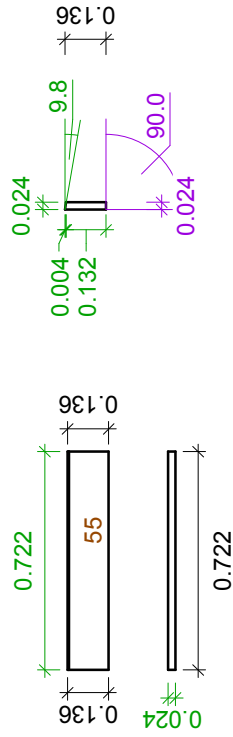

deska zamykająca: 0.024 / 0.153
 NrS x ilość: 56, 8 szt
 długość: 0.722 m
 skala: 1 : 25

